

ケリソフット

《 Device of spraying chemicals for automobile 》

For passenger cars

User manual

Please read first

「運ぶ」を支え、環境と未来をひらく

ISUZU

Higashi Hokkaido Isuzu Motors Co., Ltd.

Introduction

Thank you for purchasing the device of spraying chemicals for automobile «Clean foot».

This manual describes correct handling method and check point of spraying chemicals.

Please read this manual well and always use it properly and safely in the best condition.

After reading, please keep it in a state ready to take out.

When you lost this manual, download from below URL.

<http://www.east-hokkaido.co.jp/kankyo/cleanfoot/lineup/>

Note

We may use other parts to improve quality and performance.

In that case, please understand that it may differ from the contents of this manual partly.

About guarantee

Quality assurance of each part of the kit is done by Higashi Hokkaido Isuzu Motors Corporation. The free repair period is one year after purchase of the kit.

(Please ensure the quality assurance involved with the installation work should be done where the work was carried out.)

1. Introduction	1
2. Contents	2
3. Outline	3
4. How to use		
4-1 Tire disinfection	4
4-2 Personal disinfection with using a hand-held nozzle	5
4-3 Cautions for use	6

3-1 Features of the device

This device can spray the chemical liquid to each tire by simple operation. It will be done just push the switch while sitting in the driver's seat and slightly moving the car.

3-2 Construction of the device

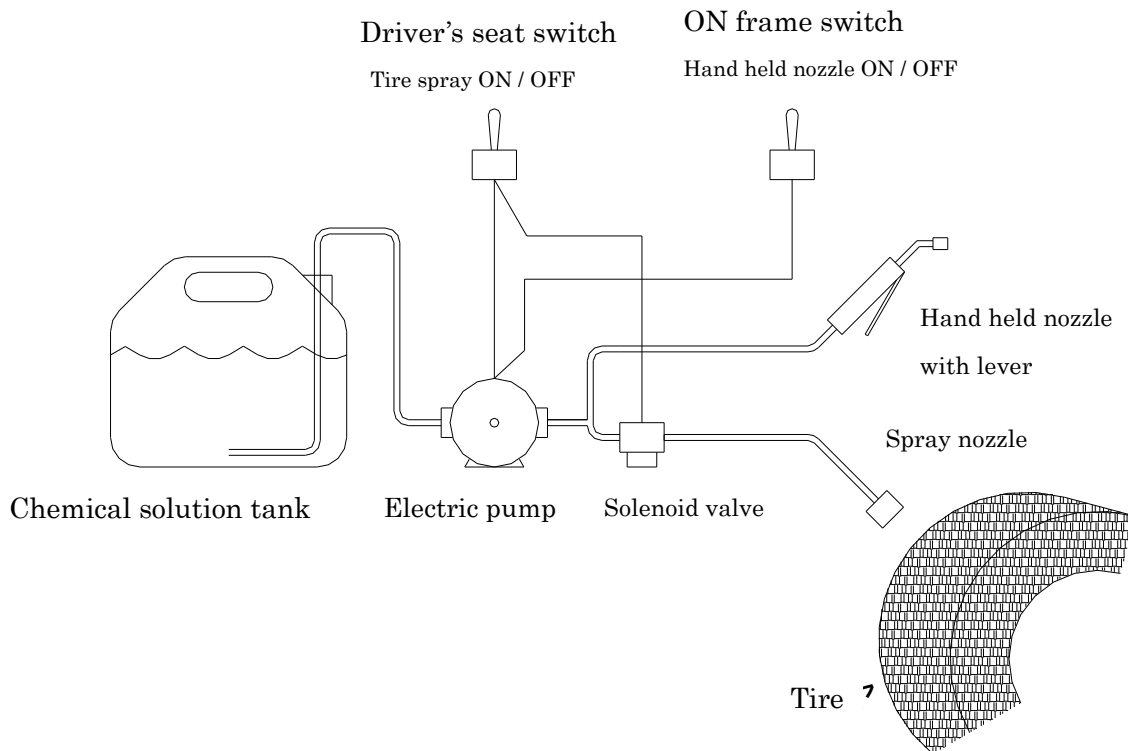

4-1 Tire disinfection

- ① Stop the car.
- ② Check the surrounding safety of your car well.
- ③ Turn ON the switch of "Clean foot" of the driver's seat. Please make sure that the chemical liquid is spraying on tires by side mirror etc.
- ④ Move slowly your car.<as to turn the tire more than one rotation>
※Normally passenger cars need about 2 meters to turn the tire one rotation.
- ⑤ Stop the car.
- ⑥ Turn off the switch of "Clean foot" of the driver's seat.



Danger

Don't use absolutely during normal driving .

The chemical liquid is sprayed strongly. Please don't use the device when people or cars are closer on your car.

Please ensure that doing safety well after considering that move your car with more one tire's rotation while spraying chemical liquid.

4-2 Personal disinfection with using a hand-held nozzle.

- ① Turn ON the ON frame switch.
- ② The chemical liquid is sprayed during the hand-held nozzle lever is holding.
- ③ **After using, ensure to turn OFF the ON frame switch.**

Important

After using the hand-held nozzle, the spraying of chemical solution stops by releasing the hand-held nozzle lever, but the device such as the pump remains in operation.

Leave as it is, it will lead to device failure, so be sure to turn OFF the ON frame switch.



Warning Never use it for people and animals.

4-3 Precautions for use

The hole of the spray nozzle, piping is clogged with mud which the tire splashed, fine dust etc. Please clean regularly spray nozzles and pipes before the clogging is severe.

For winter season

This device cannot be used if there is possibility of chemical liquid freezing. In order to use this device for a long time, we recommend that anti-freeze measures be taken during the winter by referring to the following procedure.

Procedure for anti-freeze measures

- ① Put the antifreeze liquid(Wind Washer liquid etc.) into the tank instead of the chemical solution, let it spray for a few seconds, and let the antifreeze liquid through the piping.
- ② Remove the spray nozzle with the installation bracket.
- ③ At an appropriate position, remove the hose connected to the spray nozzle. (Including hose barb nipples or screw-in position etc., please remove from an easy-removed position.)
- ④ Please plug the end of the removed hose with vinyl tape etc. so that dust will not be entered. Please tie the hoses and fix it firmly to the car body.
- ⑤ Please clean and store the parts such as nozzles that you removed.

Throughout the work, please be careful not to disturb the running of your car with removed parts or hoses.

Piping diagram May 25, 2010

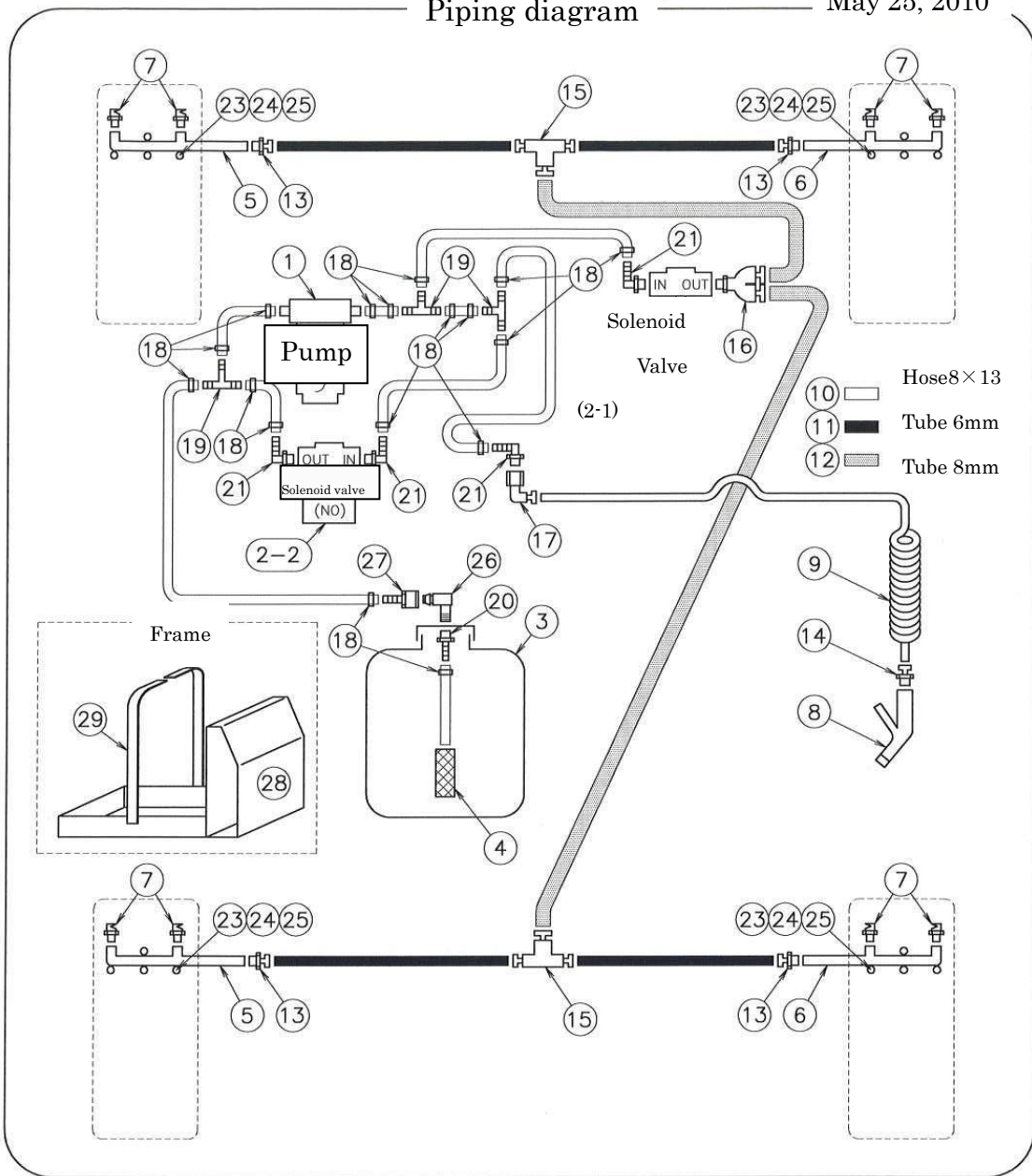

Wiring diagram

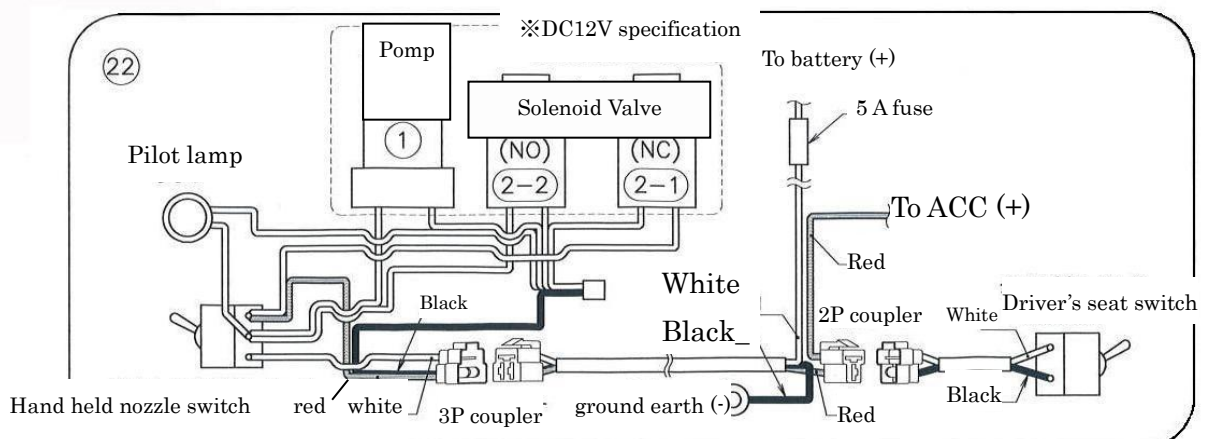

Higashi Hokkaido Isuzu Motors Co., Ltd.

Environment Division

080-2460 Obihiro City West 20 North 1 - chome 3 No. 2

TEL (0155) 58-1211 FAX (0155) 58-1232

Final revision: December 2014
